

OFFICIAL RULES



A B A

AMERICAN BADMINTON ASSOCIATION



THE American Badminton Association is the official governing body for the game of badminton within the United States of America. It is a member of the International Badminton Federation, with headquarters in London, England. The membership of the Association consists of:

1. Class A Members—These members consist of associations of five or more clubs, each of which club has six or more playing members.
2. Class B Members—These members consist of clubs of six or more playing members so situated that they cannot conveniently become affiliated with other clubs of an association. Their application must be endorsed by the nearest Class A member.
3. Class C Members—These members consist of groups of players in schools, colleges, YMCAs and municipal centers which are not represented in any association. Their application must be endorsed by the nearest Class A member.

OBJECTIVES

1. To promote and develop the game of badminton in the United States.
2. To assist in the development of clubs and associations.
3. To establish and uphold rules of play and amateur status.
4. To conduct and manage all National tournaments.
5. To sanction all sectional and State championship tournaments.
6. To act as the United States authority in any International tournaments.

THE LAWS OF BADMINTON AND THE RULES OF THE



COPYRIGHT 1941—AMERICAN
BADMINTON ASSOCIATION



INDEX

Purpose and Objectives.....	Page 2
Laws of Badminton.....	Page 4
Interpretations	Page 10
Regulations Regarding Exhibition Matches..	Page 10
Rules for Amateur Standing.....	Page 12
Rules and Regulations Covering the Annual Championship Tournament	Page 14



Revised and Adopted in 1939, by the
INTERNATIONAL BADMINTON FEDERATION
and

Amended and Adopted April 5, 1941, by the
AMERICAN BADMINTON ASSOCIATION

47 Colburn Road, Wellesley Hills 82, Mass.

Reprinted June 1946

THE LAWS OF BADMINTON

1. (a) COURT.—The court shall be laid out as in Diagram “A” (Page 5) (except in the case provided for in paragraph “b” of this Law) and to the measurements there shown and shall be defined by white, black or other easily distinguishable lines, $1\frac{1}{2}$ inches wide.

In marking the court, the width ($1\frac{1}{2}$ inches) of the center lines shall be equally divided between the right and left service-courts; the width ($1\frac{1}{2}$ inches each) of the short service line and the long service line shall fall within the 13 foot measurement given as the length of the service-court; and the width ($1\frac{1}{2}$ inches each) of all other boundary lines shall fall within the measurements given.

(b) Where space does not permit of the marking out of a court for doubles, a court may be marked out for singles only as shown in Diagram “B” (Page 5). The back boundary lines become also the long service lines, and the posts, or the strips of material representing them as referred to in Law 2, shall be placed on the side lines.

2. POSTS—The posts shall be 5 feet 1 inch in height from the floor. They shall be sufficiently firm to keep the net strained as provided in Law 3, and shall be placed on the side boundary lines of the court. Where this is not practicable, some method must be employed for indicating the position of the side boundary line where it passes under the net, e.g., by the use of a thin post or strip of material, not less than $1\frac{1}{2}$ inches in width, fixed to the side boundary line and rising vertically to the net cord. Where this is in use on a court marked for doubles it shall be placed on the side boundary line of the doubles court irrespective of whether singles or doubles are being played.

3. NET—The net shall be made of fine tanned cord of $\frac{3}{4}$ inch mesh. It shall be firmly stretched from post to post, and shall be 2 feet 6 inches in depth. The top of the net shall be 5 feet in height from the floor at the center, and 5 feet 1 inch at the posts, and shall be edged with a 3 inch white tape doubled and supported by a cord or cable run through the tape and strained over and flush with the top of the posts.

4. SHUTTLE—A shuttle shall weigh from 73 to 85 grains, and shall have from 14 to 16 feathers fixed in a cork, 1 inch to $1\frac{1}{2}$ inches in diameter. The feathers shall be from $2\frac{1}{2}$ to $2\frac{3}{4}$ inches in length from the tip to the top of the cork base. They shall have from $2\frac{1}{8}$ to $2\frac{1}{2}$ inches spread at the top and shall be firmly fastened with thread or other suitable material.

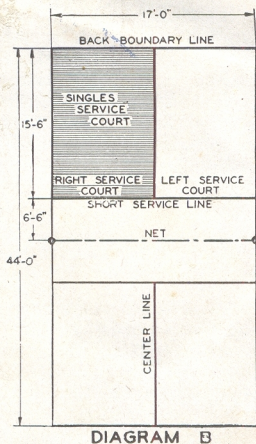
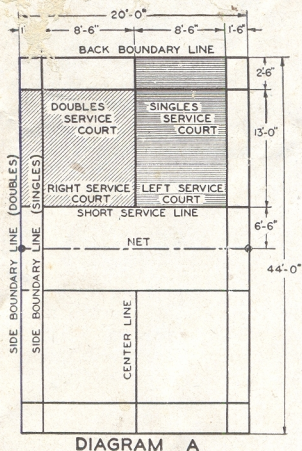

In places where atmospheric conditions, due either to altitude or climate, make the standard shuttle unsuitable the specifications in this Law may be modified subject to the approval of the National Organization concerned.

A shuttle shall be deemed to be of correct pace if, when a player of average strength strikes it with a full underhand stroke from a spot immediately above one back boundary line in a line parallel to the side lines, and at an upward angle, it falls not less than 1 foot, and not more than 2 feet 6 inches, short of the other back boundary line.

5. (a) **PLAYERS**—The word “Player” applies to all those taking part in a game.

(b) The game shall be played, in the case of the doubles game, by two players a side, and in the case of the singles game, by one player a side.

(c) The side for the time being having the right to serve shall be called the “In” side, and the opposing side shall be called the “Out” side.

6. **TOSS**—Before commencing play the opposing sides shall toss, and the side winning the toss shall have the option of:—

(a) Serving first; or (b) Not serving first; (c) Choosing Ends. The side losing the toss shall then have choice of any alternative

7. (a) SCORING—The doubles and men's singles game consists of 15 or 21 points, as may be arranged. Provided that in a game of 15 points, when the score is 13 all, the side which first reached 13 has the option of "setting" the game to 5, and that when the score is 14 all, the side which first reached 14 has the option of "setting" the game to 3. After a game has been "set" the score is called "love all," and the side which first scores 5 or 3 points, according as the game has been "set" at 13 or 14 all, wins the game. In either case the claim to "set" the game must be made before the next service is delivered after the score has reached 13 all or 14 all. Provided also that in a game of 21 points the same method of scoring be adopted, substituting 19 and 20 for 13 and 14.

(b) The ladies' single game consists of 11 points. Provided that when the score is "9 all" the player who first reached 9 has the option of "setting" the game to 3, and when the score is "10 all" the player who first reached 10 has the option of "setting" the game to 2.

(c) A side rejecting the option of "setting" at the first opportunity shall not be thereby debarred from "setting" if a second opportunity arises.

(d) In handicap games "setting" is not permitted.

8. The opposing sides shall contest the best of 3 games, unless otherwise agreed. The players shall change ends at the commencement of the second game and also of the third game (if any). In the third game the players shall change ends when the leading score reaches:—

- (a) 8 in a game of 15 points;
- (b) 6 in a game of 11 points;
- (c) 11 in a game of 21 points;

or, in handicap events, when one of the sides has scored half the total number of points required to win the game (the next highest number being taken in case of fractions). When it has been agreed to play only one game the players shall change ends as provided above for the third game.

If, inadvertently, the players omit to change ends as provided in this Law at the score indicated, the ends shall be changed immediately the mistake is discovered, and the existing score shall stand.

9. (a) DOUBLES PLAY—It having been decided which side is to have the first service, the player in the right-hand service-court of that side commences the game by serving to the player in the service-court diagonally opposite. If the latter player returns the shuttle before it touches the ground, it is to be returned by one of the "in" side, and then returned by one of the "out" side, and so

on, till a fault is made or the shuttle ceases to be "in play" (see paragraph (b)). If a fault is made by the "in" side, the servers' hand is out, and as the side beginning a game has only one hand in its first innings (see Law 11), the player of the opposing side in the right-hand service-court now becomes the server; but if the service is not returned, or the fault is made by the "out" side, the "in" side scores a point. The "in" side players then change from one service-court to the other, the service now being from the left-hand service-court to the player in the service-court diagonally opposite. So long as a side remains "in," service is delivered alternately from each service-court into the one diagonally opposite, the change being made by the "in" side when, and only when, a point is added to its score.

(b) The first service of a side in each inning shall be made from the right-hand service-court. A "Service" is delivered as soon as the shuttle is struck by the server's racket. The shuttle is thereafter "in play" until it touches the ground, or until a fault or "let" occurs. After the service is delivered, the server and the player served to may take up any positions they choose on their side of the net, irrespective of any boundary lines.

10. The player served to may alone receive the service, but should the shuttle touch, or be struck by, his partner the "In" side scores a point. No player may receive two consecutive services in the same game.

11. The side beginning a game has only one hand in its first innings. In all subsequent innings each partner on each side has a hand, the partners serving consecutively. The side winning a game shall always serve first in the next game, but either of the winners may serve and either of the losers may receive the service.

12. If a player serves out of turn, or from the wrong service-court (owing to a mistake as to the service-court from which service is at the time being in order), *and his side wins the rally*, it shall be a "Let," provided that such "Let" be claimed or allowed before the next succeeding service is delivered.

If a player standing in the wrong service-court takes the service, *and his side wins the rally*, it shall be a "Let," provided that such "Let" be claimed or allowed before the next succeeding service is delivered.

Should a player inadvertently change sides when he should not do so and the mistake not be discovered until after the next succeeding service has been delivered, the mistake shall stand. Players shall continue in their changed positions and a "let" cannot be claimed or allowed.

13. SINGLES PLAY—In singles Laws 9 to 12 hold good except that:—

(a) The players shall serve from and receive service in their respective right-hand service-courts only when the servers score is 0, or when he has scored an even number of points in the game, the service being delivered from and received in their respective left-hand service-courts when the server has scored an odd number of points.

(b) Both players shall change service-courts after each point has been scored.

14. FAULTS—A fault made by a player of the side which is “in,” puts the server out; if made by a player whose side is “out,” it counts a point to the “In” side.

It is a fault:—

(a) If in serving, the shuttle at the instant of being struck be higher than the server’s waist, or if any part of the head of the racket, at the instant of striking the shuttle, be higher than any part of the server’s hand holding the racket.

(b) If, in serving, the shuttle falls into the wrong service-court, (i.e., into the one not diagonally opposite to the server), or falls short of the short service line, or beyond the long service line, or outside the side boundary lines of the service-court into which service is in order.

(c) If the server’s feet are not in the service-court from which service is at the time being in order, or if the feet of the player receiving the service are not in the service-court diagonally opposite until the service is delivered. (See Law 16).

(d) If before or during the delivery of the service any player makes preliminary feints or otherwise intentionally balks his opponent.

(e) If, either in service or play, the shuttle falls outside the boundaries of the court, or passes through or under the net, or fails to pass the net, or touches the roof or side walls, or the person or dress of a player. (A shuttle falling on a line shall be deemed to have fallen in the court or service-court of which such line is a boundary).

(f) If the shuttle “in play” be struck before it crosses to the striker’s side of the net. (The striker may, however, follow the shuttle over the net with his racket in the course of his stroke).

(g) If, when the shuttle is “in play,” a player touches the net or its supports with racket, person or dress.

(h) If the shuttle be hit twice in succession by the same player, or be hit by a player and his partner successively, or if the shuttle be not distinctly hit (See Interpretation 2).

(i) If in play a player strikes the shuttle (unless he thereby

makes a good return), or is struck by it, whether he is standing within or outside the boundaries of the court.

(j) If a player obstructs an opponent.

(k) If Law 16 be transgressed.

15. GENERAL—The server may not serve till his opponent is ready, but the opponent shall be deemed to be ready if a return of the service be attempted.

16. The server and the player served to must stand within the limits of their respective service-courts (as bounded by the short and long service, the central, and side lines), and some part of both feet of these players must remain in contact with the ground in a stationary position until the service is delivered. A foot on or touching a line in the case of either the server or the receiver shall be held to be outside his service-court. (See Law 14(c)). The respective partners may take up any position, provided they do not unsight or otherwise obstruct an opponent.

17. If, in service, the shuttle touches the net it is a "Let," provided the service be otherwise good. If in the course of a rally the shuttle touches and passes over the net it does not invalidate the stroke. It is a good return if the shuttle having passed outside either post drop on or within the boundary lines of the opposite court. A "Let" may be given by the umpire for any unforeseen or accidental hindrance.

If, in service, the shuttle strikes the top of the net, and is then struck or touched by the player served to, it is assumed that the shuttle would have fallen into the proper service-court, and it is a "Let."

If, in service, or during a rally, a shuttle, *after passing over the net*, is caught in or on the net, it is a "Let." When a "Let" occurs, the play since the last service shall not count and the player who served shall serve again.

18. If the server, in attempting to serve, misses the shuttle, it is not a fault; but if the shuttle be touched by the racket, a service is thereby delivered.

19. If, when in play, the shuttle strikes the net and remains suspended there, or strikes the net and falls towards the ground on the striker's side of the net, or hits the ground outside the court and an opponent then touches the net or shuttle with his racket or person, there is no penalty, as the shuttle is not *then* in play.

20. If a player has a chance of striking the shuttle in a downward direction when quite near the net, his opponent must not put up his racket near the net on the chance of the shuttle rebounding from it. This is obstruction within the meaning of Law 14(j).

A player may, however, hold up his racket to protect his face from being hit if he does not thereby balk his opponent.

21. It shall be the duty of the umpire to call "fault" or "let" should either occur, without appeal being made by the players, and to give his decision on any appeal regarding a point in dispute, if made before the next service; and also to appoint linesmen at his discretion. An umpire's decision shall be final, but he shall uphold the decision of a linesman. Where, however, a referee is appointed, an appeal shall lie to him from the decision of an umpire on question of law only.

INTERPRETATIONS

1. Any movement or action by the server that has the effect of breaking the continuity of service after the server and receiver have taken their positions to serve and to receive the service is a preliminary feint. (See Law 14(d))

2. It is a fault under Law 14(h) :—

(a) If the shuttle be held on the racket during the execution of a stroke, i.e., if it be caught and slung instead of being distinctly hit, or

(b) If the shuttle be hit twice during the execution of a stroke.

3. But it is *not* a fault (provided the stroke be otherwise legitimate) :

(a) If the base and feathers of the shuttle be struck simultaneously.

(b) If the shuttle be struck by any part of the frame of the racket.

4. It is obstruction if a player invade an opponent's court with racket or person in any degree except as permitted in Law 14(f) .

(See Law 14(j))

5. Where necessary on account of the structure of a building, the local Badminton Authority may, subject to the right of veto of its National Organization, make by-laws dealing with cases in which a shuttle touches an obstruction.

REGULATIONS REGARDING EXHIBITION MATCHES

EXHIBITION MATCHES—NO ADMISSION CHARGE

Such matches may be carried out at any time without authority, except for any Class A Association special ruling within its own jurisdiction, and amateurs may play with or against pro-

fessionals without restriction, except that amateurs shall in no way receive money in excess of actual travelling and living expenses incurred.

EXHIBITION MATCHES—ADMISSION CHARGE

1. *Between Amateurs Only*

Such matches may be authorized by the American Badminton Association Amateur Status Committee or its Sub-Committee duly appointed for the region involved when submitted and approved by the Class A Badminton Association concerned under the following conditions:

(a) When evidence is submitted that the proposed match is definitely for the purpose of promoting badminton in an individual club, a district, or under exceptional circumstances, to raise funds for the transportation of players to sectional, national or international tournaments, or for charitable purposes.

(b) When the proposed match is to be conducted under the auspices of the American Badminton Association, a Class A Association, an affiliated club or a recognized and reliable organization.

(c) Providing the responsible organization shall, if requested by the authorizing authority, present to the Secretary of the American Association a duly audited financial statement showing receipts and disbursements.

(d) Providing that all amateurs in these exhibitions receive in money or the equivalent, only their actual travelling and living expenses incurred. (See rules for amateur status, Sections 1(g) and 2(e).)

2. *Between Amateurs and Professionals*

Such matches may be authorized by the American Badminton Association Amateur Status Committee or its Sub-Committee duly appointed for the region involved under the conditions of the preceding rulings (1—a, b, c, d).

This shall also apply to matches in which both amateurs and professionals take part, but where the latter do not compete against the former.

AMATEUR PLAYERS OF THE AMERICAN BADMINTON ASSOCIATION COMPETING IN EXHIBITION MATCHES IN FOREIGN COUNTRIES

Players in the United States affiliated with the American Badminton Association may take part in exhibition matches in other countries under the provisions of the preceding rulings (excepting 1—b, 1—c). The above exhibitions shall have been duly approved by the governing body or by authority

duly delegated by that body, of the country or countries concerned.

SANCTION FEE

Any club or organization holding an exhibition as sanctioned under Sections 1 and 2 shall pay to the ABA a sanction fee of \$2.00 except that when a professional receives payment for his or her services, the Sanction Fee then becomes \$5.00.

RESTRICTION OF EXPENDITURES

Expenditures (excluding expenditures for prizes) in respect to such matches shall be restricted in nature and in the same manner, and to the same extent as provided by the regulations for the United States Championships. Other proposed expenditures, including players, seating and advertising expenses, must first be approved by the District and Class A Association.

RULES FOR AMATEUR STANDING

PREAMBLE

The rules for determining amateur status are divided into two sections. Section 1 lists and defines certain activities which ipso facto exclude any who engage in them from competition as amateurs. Section 2 lists and defines certain "borderline" activities which may jeopardize the amateur status of anyone engaging in them without the consent of the Committee on Amateur Status.

In considering cases under Section 2, the Committee on Amateur Status and its sub-committees should consider carefully the attitude and conduct of the person involved. A warning may be issued in cases where the Committee feels that infractions have been committed through ignorance or because of other extenuating circumstances.

1. *Forfeiture of Amateur Status.* A player will be considered to have forfeited his or her amateur status by committing any of the following acts:

- (a) By entering a competition open only to professionals.
- (b) By playing for a money prize or gate receipts.
- (c) By playing, coaching, instructing or demonstrating badminton or any racket game either orally or in writing as a means of livelihood or for remuneration.
- (d) By maintaining badminton facilities or facilities for any game played with a racket as a chief means of livelihood.

(e) By obtaining or retaining membership in any Badminton club because of any mutual understanding, expressed or implied, whereby such membership would be of pecuniary benefit to the member.

(f) By selling, pledging or otherwise converting into money or what is commonly known as necessities such as food, ordinary clothing, etc., any prize won in a badminton match or tournament, or by accepting as a prize such article.

(g) By accepting money or gaining pecuniary advantage from using the goods of a manufacturer, agent, or merchant, or by permitting himself to be advertised as a user of such goods, or by receiving in money or the equivalent an excess above their actual travelling and living expenses incurred when participating in either tournaments or exhibition matches.

(h) By permitting or sanctioning the taking of badminton action pictures of himself and receiving remuneration in connection therewith.

2. Where forfeiture is discretionary with the American Status Committee.

A player may be declared ineligible to compete in tournaments or matches played under the auspices of this association by committing any of the following acts except with the consent of the Amateur Status Committee:

(a) By being connected with the sale or repair of Badminton goods in any way that could or would cause his or her income to be enhanced by such connection.

(b) By using or sanctioning the use of his titles or statement of his reputation won on the badminton courts in connection with books, newspaper, magazine or other written articles, motion pictures of himself, lectures or radio talks, for which he is to receive any payment or compensation.

(c) By writing for pay or for a consideration current newspaper articles covering a tournament or match in which he is entered as a competitor.

(d) By playing in a tournament, team or exhibition match where professionals play and where gate receipts are charged, unless permission to hold such match has been obtained in advance from the Amateur Status Committee or from an authorized Committee of the Class A association under the jurisdiction of which such event is to take place. (See Section 5 below.)

(e) By failing after reasonable notice to supply the American Badminton Association with signed reports of expenses received or paid for him, together with such additional information in

connection therewith as may be required by the Amateur Status Committee or by a committee appointed for that purpose.

(f) By being engaged in the sporting good business and failing after reasonable notice to supply the American Badminton Association with signed reports of his employment as required by the Amateur Status Committee or by a committee appointed for that purpose.

(g) By being guilty of unsportsmanlike conduct.

(h) By being barred from amateur competition by any other sports governing body.

(i) By participating in an exhibition or tournament that has not been truly authorized or sanctioned.

3. Any player who is declared ineligible may be recommended for reinstatement by the Amateur Status Committee on evidence satisfactory to it that reinstatement is merited, the Amateur Status Committee thereby expressly waiving the fifty-two week period provided for in Section No. 4.

4. Any player who has been engaged in professional activities, may upon submission of satisfactory evidence of abstinence from such activities for a period of not less than fifty-two (52) consecutive weeks, make application to the Amateur Status Committee for reinstatement. The Amateur Status Committee may recommend reinstatement upon application as above, when evidence indicates such reinstatement is merited. There shall be no presumptive right of such reinstatement.

5. The Amateur Status Committee may at its discretion authorize an appropriate committee of each Class A association to act for it, subject to its regulations, with respect to players who are affiliated with and events which are to take place within the jurisdiction of such Class A association.

6. Anything herein to the contrary notwithstanding, no player who has become a professional, earning a substantial part of his or her income by engaging in such commercial activities as teaching badminton or playing in badminton exhibitions, shall qualify for reinstatement as an amateur.

RULES AND REGULATIONS COVERING THE ANNUAL CHAMPIONSHIPS TOURNAMENT OF THE AMERICAN BADMINTON ASSOCIATION

1. The Annual Championships shall be held in the Spring of each year, at such place and upon such dates as may be approved by the Executive Committee.

2. Competition shall be restricted to amateurs, who are members of clubs which are members of the American Badminton Association in good standing, provided they are citizens of the United States or aliens who have established residence within the United States for a period of six years preceding the Championships Tournament.

3. Applications from associations or member clubs in good standing desiring the allocation of the Championships Tournament must be filed in writing with the Secretary-Treasurer at least sixty days prior to the Annual Meeting next preceding the Tournament desired.

4. The Annual Championships shall include the following official events: Ladies' Singles, Ladies' Doubles, Men's Doubles, Mixed Doubles and Veteran's Doubles. Subject to the approval of the Executive Committee, the organization holding the Championships may eliminate any event.

Players under 16 years of age will not be eligible to compete in the National Championships. The age limit for the Veteran's Doubles Event has been fixed at 40 years. The above age limitations are effective as of the first day of the Annual Championships.

5. The Grant System of play shall be used in conducting the Annual Championships.

6. Any player winning or participating with another player in winning an official Annual Championship event will thereafter be entitled to wear the "Winner Blazer" of the American Badminton Association.

7. Each of the members of a team winning the Veteran's Doubles event at an Annual Championships Tournament shall thereafter be entitled to wear the "Veterans' Blazer" of the American Badminton Association.

8. Provided the finances of the American Badminton Association permit, and subject to the approval of the Executive Committee, each qualified title-holder, except the Veteran's Doubles title-holders, shall be entitled to receive an amount equal to railroad fare and Pullman lower berth or parlor car accommodations from his or her temporary or permanent place of residence to the place where the annual Championships are being held, and return.

(a) In the case of a doubles team, this ruling applies only when both members of a team enter the Championships as a team.

(b) In no case shall the amount received exceed the actual disbursement by the title-holder for transportation.

(c) All players entitled to any allowance shall be notified by the Secretary-Treasurer of the ABA of the approximate amount to be allowed not less than thirty days preceding the Championships.

(d) Signed expense accounts for transportation must be submitted to the Executive Committee for ratification of payment.

9. Any surplus resulting from the operation of the Annual Championships Tournament shall be divided 25% to the club operating the Tournament, 25% to the Class A Association sponsoring the Tournament, and 50% to the American Badminton Association. In the event that a Class A Association should of itself operate a Tournament its participation in the surplus shall be 50%.

10. The association or member club operating the Championships Tournament shall include the sum of seven hundred and fifty dollars (\$750), (or such other sum as the Executive Committee may designate), in their operating budget, which amount shall be considered as an expense of Tournament operation and shall be paid to the American Badminton Association for the primary purpose of defraying the expenses contemplated in Paragraph 8 hereof.

